

New Tamedia timber office building

Zurich, CH



Project details

Client	Tamedia AG
Architecture	Shigeru Ban Architects
Project type	Office and administration
Construction type	Free Form
Services	Timber construction
Construction	2012
Locality	Zurich
Country	Switzerland

Tamedia head office is Switzerland's first seven-storey timber structure

Near the main railway station in the centre of Zurich, a visionary office building completed in May 2013 demonstrates the potential of wood as a material for large-scale urban structures. Pritzker Prize winner Shigeru Ban is renowned just as much for his striking timber constructions as for his humanitarian buildings in crisis-affected areas. The aim is to put the skeletal supporting framework together like a modular concept, leaving the static system visible and the wood elements exposed. Precise, innovative planning paired with a special hardwood filling, high quality materials, CNC production and a refined assembly concept enabled the high demands of the client and architect to be met.

Specific Contact



Richard Jussel

Project Development | Sales – Industrial Buildings | Timber and Modular Construction | Switzerland

T +41 71 388 58 61

richard.jussel@blumer-lehmann.com

New Tamedia timber office building

Zurich, CH



7-storey office building



Exposed support structure inside the building

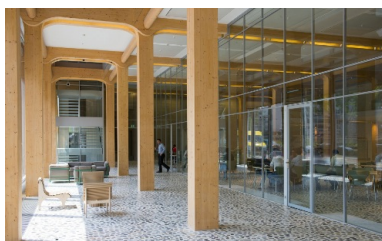

Open-plan reception area

High glass frontages on the top floor