

Wood pavilion for Innovation Park Zurich

Dübendorf, CH



Project details

Client	Stiftung Switzerland Innovation Park Zurich
Architecture	FAT Architects
Project type	Temporary buildings, Education and research, Art and culture
Construction type	Free Form, Wood element construction, Modular construction
Services	JC
Construction	2017
Locality	Dübendorf
Country	Switzerland

Information pavilion with magnetic effect for Switzerland Innovation Park Zurich

Situated on the former airfield in Dübendorf, Switzerland Innovation Park Zurich has a vision to bring together the knowledge and ideas from universities with the private sector and develop innovations for the world of tomorrow. The pavilion is designed as open street furniture and offers a high quality visitor experience. Meetings and discussion are central to the concept.

Blumer-Lehmann AG was involved with the project as the timber construction planner, manufacturer, full-service general contractor and lessor. The room modules were prefabricated in our factory and combined with the primary and secondary supporting structure on site. Free-form, sustainable, modular timber construction creates an inspiring environment and provides space for ideas and innovative solutions.

Specific Contact



Migga Hug

Head of GC & TC Services |
Architectural planning | Switzerland
Member of the Division Management

T +41 71 388 58 23
migga.hug@blumer-lehmann.com

Wood pavilion for Innovation Park Zurich

Dübendorf, CH



Lighthouse project for the Innovation Park



Entrance area in the free-form shell

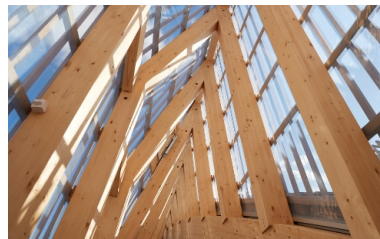

Modules for offices and meeting rooms
Support structure envelops the modules